

Prestige Industrial Park

2801 EAST 2ND STREET GILLETTE, WY 82718

- Shovel Ready Sites
- Lot 1
- Lot 3
- Lot 5B
- Lot 6B
- Industrial Zoning
- Innovative Solutions
- Build to Suit
- Easy I-90 Access
- Anchor Tenants include:
- Cummins
- Gazelle
- Consolidated Oil Well Services
- United Rentals

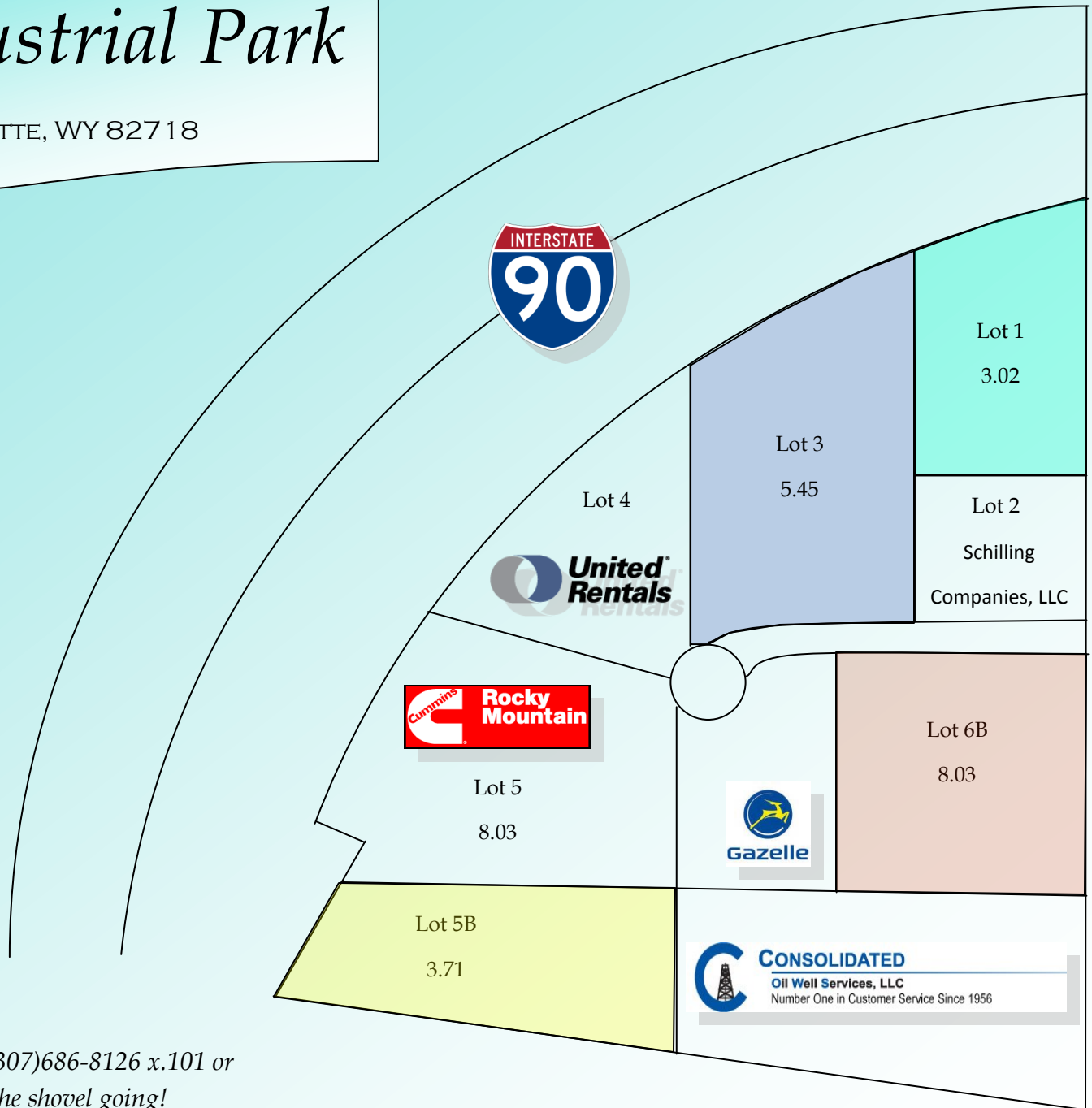

Don't hesitate to call Wendy Jaqua at (307)686-8126 x.101 or (307)660-9211 – we would love to get the shovel going!